



ROBERT NASH ACIS DMS
Clerk to the Town Council

THE TOWN COUNCIL
OF
ROYAL LEAMINGTON SPA
TOWN HALL, PARADE,
ROYAL LEAMINGTON SPA
WARWICKSHIRE CV32 4AT
T: 01926 450 906 F: 01926 456 901
E: rnash@towncouncil.spacomputers.com
www.leafingtonspatowncouncil.gov.uk

22nd June 2012

Dear Councillor,

A meeting of the Cultural and Community Committee will be held in Meeting Room 5 at the Town Hall, Parade, Royal Leamington Spa on **THURSDAY 28th JUNE 2012 commencing at 6.30 pm.**

The business will be as set out below.

Yours faithfully,

Clerk to the Town Council

To:- Councillors J. Clarke, R. Copping, G. Dulay, S. Ingleby, S. Lytton, Y. Moore, Mota Singh and A. Stevens.

Mr J. Mather and Mr M. Crawshaw (Leamington International Twinning Society)

(All other Members of the Town Council – Agenda for information only)

AGENDA

1. **APOLOGIES FOR ABSENCE**
2. **DECLARATIONS OF INTEREST**
Members are invited to declare any interest they may have in an item identified for discussion at the Meeting.
3. **PUBLIC FORUM**
To receive representations from Members of the public in accordance with Council Standing Orders
4. **MINUTES**
To approve and sign as a correct record the Minutes of the Meeting of the Cultural and Community Committee held on 31ST May 2012 (Report No. 4)

5. MATTERS ARISING FROM THE MINUTES
6. TOWN TWINNING

To consider matters arising in relation to Town Twinning, including assessment of the recent Twinning visit of Heemstede. Representatives of LITS will be in attendance for this item.
7. CHRISTCHURCH GARDENS – COMMEMORATIVE PLANTING PROJECT

To consider the attached Report (Report No. 7)
8. ROYAL JUBILEE – BUDGET OUT-TURN

To note the expenditure incurred to date on the budget for Community celebrations for the Diamond Jubilee
9. GUILD OF GUIDES WALKS 2012

To consider a review of the volunteer programme of guided walks. The Town Clerk will report on issues relating to the suspension of the Walk Programme in 2012.
10. FAIRTRADE INITIATIVE

Town Clerk to report on the Fairtrade volunteer information point at the Peace Festival on the week-end of 16th-17th June.
11. ARRIVAL OF OLYMPIC TORCH – 1ST JULY, 2012

To note arrangements for the arrival of the Olympic Torch in Leamington on 1st July and Town Council information point at Pump Room Gardens

**MINUTES OF A MEETING OF THE CULTURAL AND COMMUNITY COMMITTEE HELD
ON 31ST MAY 2012 AT THE TOWN HALL LEAMINGTON SPA**

Present: Councillors J. Clarke (Chairman), R. Copping, G. Dulay, S. Ingleby, S. Lytton, Y. Moore, Mota Singh and A. Stevens.

Also present: Mr M. Crawshaw and Mr T. Bass (Leamington International Twinning Society).

An apology for absence was received from John Mather (Leamington International Twinning Society).

1. ELECTION OF CHAIRMAN

It was proposed by Councillor Singh, seconded by Councillor Ingleby that Councillor Clarke is appointed Chairman of the Cultural and Community for the municipal year 2012/13. There being no other nominations,

RESOLVED that Councillor J. Clarke is appointed Chairman of the Cultural and Community Committee for the municipal year 2012/13.

2. ELECTION OF VICE-CHAIRMAN

It was proposed by Councillor Moore, seconded by Councillor Stevens, that Councillor Copping is elected Vice-Chairman of the Cultural and Community Committee for the Municipal year 2012/13.

RESOLVED that Councillor R. Copping is elected Vice-Chairman of the Cultural and Community Committee for the Municipal year 2012/13.

3. PUBLIC FORUM

There were no Members of the Public in attendance.

4. MINUTES

RESOLVED that the Minutes of the Meeting of the Cultural and Community Committee held on 2nd April, 2012 are confirmed and signed as a correct record.

5. TOWN TWINNING

The Chairman welcomed Mr Crawshaw and Mr Bass to the meeting.

Mr Crawshaw reminded the Committee that a delegation from the Town of Bruhl would be visiting Leamington over the period of September 2012 and it was anticipated that an indication would be required of the number of delegates from Leamington attending the proposed Conference at Bruhl in September 2013. The Committee was reminded that the Conference proposal, which had been considered

at the Meeting of the Committee on 2nd April, was subsequently endorsed by the Town Council subject to further clarifying the role of the Council and an estimate of the costs involved in hosting a Conference at Leamington, provisionally agreed to take place in 2014.

The Town Clerk advised that the Conferences were intended to broaden the appeal of Twinning and to encourage greater engagement with groups within the community of each of the four Towns, thus enabling wider appreciation of culture and local custom. It was imperative that a process of engagement with the wider community be commenced to establish potential interest and availability in attending the Conferences.

The Committee endorsed commencing early consideration of this matter and agreed that a Working Group should be the preferred approach to enable as wide a representation as possible.

RESOLVED

- (i) that a Working Group comprising Councillors Clarke, Copping, Ingleby and Stevens together with representatives of Leamington International Twinning Society is convened to determine potential representation of the wider community at the roundtable Conferences to be held in the period 2013/2014.
- (ii) that clarification is obtained on the availability of funding support for meeting delegates costs.

Mr Crawshaw and Mr Bass then left the Meeting.

Note: In accordance with the National Code of Conduct, Councillors Clarke, Copping, Moore, Singh and Stevens declared personal interests in the above item by reason of being members of the Leamington International Twinning Society, remained in the meeting and took part in the discussion and voting thereon.

6. INSTALLATION OF AUTOMATED EXTERNAL DEFIBRILLATOR (AED)

Consideration was given to a Report (Report No.9) from Councillor Copping regarding the provision of an Automated External Defibrillator (AED) on an external wall of the Town Hall.

Councillor Copping explained that unlike some other villages and Towns in the District, Leamington did not benefit from an AED which could potentially save a life in the case of someone suffering a cardiac arrest. It was envisaged that a group of up to nine volunteers would need to be trained in the use of this device and a person appointed to maintain a register of users and initiate training. The proposed location of the device on an external wall of the Town Hall would require Listed Building consent and connection to the electricity supply approval of Warwick District Council.

Whilst the cost of the device and a protective box would be met by a donation from the Royal Leamington Spa Round Table, the additional cost of connection to the electricity supply and replacement battery packs would cost in the region of £190.00

The Committee was generally supportive of the proposal in principle, subject to the approval of the District Council and the grant of Listed Building consent. A concern was also raised in relation to the question of insurance for those operating the device as these individuals would be acting in the role of volunteers.

RESOLVED to RECOMMEND the Council

(i) that the provision of an Automated External Defibrillator (AED) at the Town Hall is supported, subject to the granting of Listed Building consent and the approval of Warwick District Council;

(ii) that a financial contribution of £190 is made to meet the cost of connection to the electricity supply and the purchase of replacement battery packs

(iii) that the Town Clerk pursues inquiries with the Council's insurer's to determine the question of liability for persons undertaking the role of first responders when operating the AED at the Town Hall.

7. ROYAL JUBILEE CELEBRATIONS

Consideration was given to the Minutes of the meetings of the Royal Jubilee Working Party held on 30th April and 24th May.

The Town Clerk reported that the Jubilee Working Group had agreed disbursements of £2888 from the budget of £10,000 allocated by the Town Council in respect of the following:-

BID Jubilee Party:-	
Hire of large screen TV	£2500
Community Arts Workshop	£750
Old Town Business Association – Street Party	£1000
Olympic Torch Fun Day (WDC)	£2500
Street Party Insurance premiums	£362

In addition, application had been made by the organisers of the Lillington Community Fun Day to be held on 27th July to commemorate both the Royal Jubilee and the Olympic Games. In view of the funding commitment to the Old Town area, it was proposed that a grant of £500 be made toward meeting the funding shortfall identified by the organisers. The proposal was seconded and it was

RESOLVED that a grant of £500 is made to the Lillington Community Fund Day on 27th July, 2012.

The Town Clerk reported a request from Warwick District Council to introduce some additional planting of spring flowering bulbs to the newly landscaped areas of Christchurch Gardens as a commemoration of the Royal Jubilee. The estimate cost of this project was £4,500.

RESOLVED that consideration of the planting proposal at Christchurch Gardens is deferred to await a submission of the costs involved in the Project.

8. **GUILD OF GUIDES WALKS**

The Town Clerk reported that discussions were taking place with the volunteer guides to develop a programme of guided walks for the period June – August 2012. The availability of volunteers was critical to continuation of the programme and in view of the fact that two of the existing guides were unavailable for the current season, it was inevitable that it would need to be curtailed to a maximum of three days per week. Discussions were continuing and it was hoped that a revised programme would be composed in the next few weeks.

RESOLVED that the Report is noted.

9. **COMMUNITY GRANTS**

Consideration was given to a Report from Warwickshire Clubs for young people which had benefitted from a Community Grant in the sum of £2,000 for a five day personal development programme for young people at an outdoor recreational centre in North Wales.

The Committee welcomed the report and noted the positive outcomes of the Project.

RESOLVED that the Report is noted.

The Meeting commenced at 6.30 pm and ended at 8.05 pm.

REPORT TO A MEETING OF THE CULTURAL AND COMMUNITY COMMITTEE TO BE HELD ON 28TH JUNE 2012

CHRISTCHURCH GARDENS COMMEMORATIVE PLANTING PROJECT

1. INTRODUCTION

- 1.1 The Committee will recall that at the meeting on 31st May, initial consideration was given to a request from Warwick District Council to contribute to the cost of a scheme of bulb planting at Christchurch Gardens in commemoration of the Royal Diamond Jubilee.
- 1.2 The Committee noted the anticipated cost of approximately £4500 and requested further detail. It was also suggested that the costs of any such planting scheme might be mitigated by involving volunteers as part of a community initiative to undertake the planting.
- 1.3 The Report provides further information on the proposal.

2. CHRISTCHURCH GARDENS

- 2.1 Christchurch Gardens has been subject to a jointly funded programme of renewal following the establishment of a joint working party of the District and Town Councils. The Project which has been funded by contribution from both the District and Town Councils has thus far delivered the following improvements:-

Removal of dead, diseased and inappropriately located trees/shrubs
Replanting of new trees and shrubs in re-designated locations
Repair of Tennis Court Fencing and Gates
Removal of some unofficial pathways
Installation of ornamental fencing to protect the new planting and discourage the formation of new "desire lines" across the Gardens.

The final phase of the Project concerned the upgrading of the retaining walls and some re-grading of levels together with improvements to the existing footpaths. Estimates for the cost of this work are still awaited.

- 2.2 The planting proposal now being suggested would provide early spring colour to the area immediately fronting Clarendon Avenue and alongside Kenilworth Road and Beauchamp Road (see map attached). Other advantages of the proposal are that it would provide an element of social calming, increase biodiversity and, once established, would be self-sustaining with no on-going maintenance.
- 2.3 The quotation reported at the last meeting was not based on a formal estimate. However it was calculated on the basis of planting approximately 100 bulbs per m², (600m² = approx. 60,000 bulbs). At commercial rates this would equate to a cost of £7.50 per m² = £4500.

To plant 60,000 bulbs by hand could be done but over a number of seasons. For example, the District Council suggests 6,000 bulbs could be planted in 3hrs with 10 volunteers.

- 2.4 There are several options which will influence the final cost of this project. Most obviously the area to be planted could be restricted to area A and C, or just area B, planting by hand, or machine. The machine price may vary depending on the area to be planted. As a community project, the cost could be further reduced to that of the purchase costs of the bulbs (plus any supervision). Bulbs cost in the region of £50-55 per thousand so £3,300 of bulbs spread over a number of seasons would equate to £1100 per year over 3 years. This option would of course require the identification of suitable numbers of volunteers.
- 2.5 The Council has provided significant funding for the Christchurch Gardens Project but this has now all been exhausted. Therefore the Committee would need to recommend the Council to approve a source of expenditure for this project, possibly as part of a future budget.

3. RECOMMENDATION

- 3.1 The proposal to fund the planting scheme of spring bulbs at Christchurch Gardens is submitted by the District Council as a means of providing a visually attractive vista in the spring that will complement the other works recently undertaken in the Gardens. This will have the ancillary benefit of eventually saving the District Council some funding associated with routine maintenance. The proposal has been put forward to establish the Council's willingness to make a financial contribution.
- 3.2 The Council has no budget set aside for this though there remains some limited funding after the costs of the Jubilee and Olympic torch celebrations have been funded. The current balance on this account is £2225. If the remaining balance of funding for the Jubilee/Olympics were to be allocated to a phased programme of planting as outlined in paragraph 2 above, the project could potentially commence this autumn.
- 3.3 The Committee's instructions are requested.

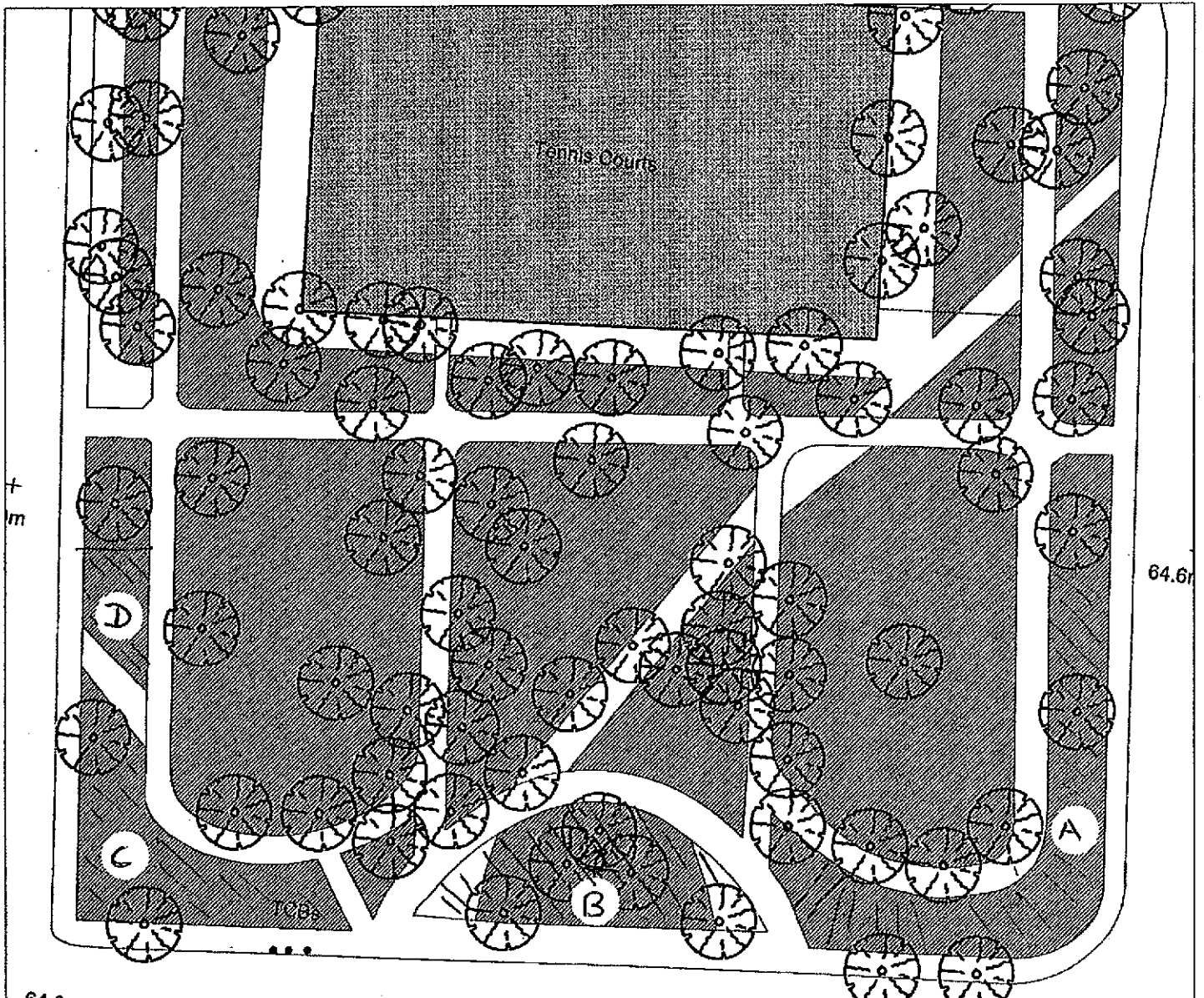

CLARENDON AVENUE

Lunn Poly House

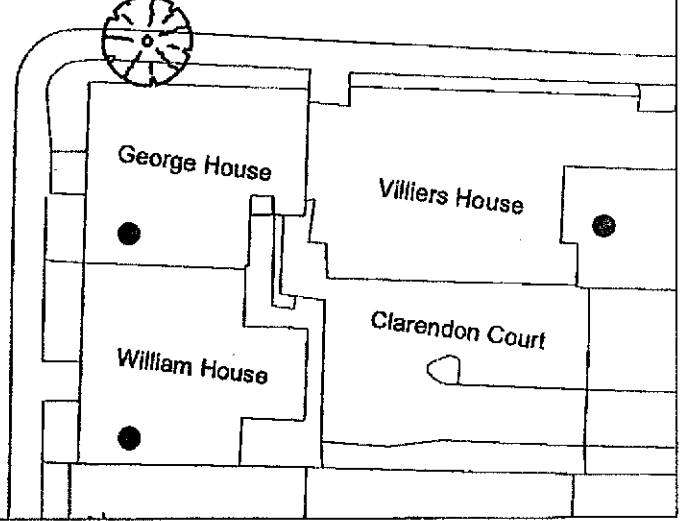
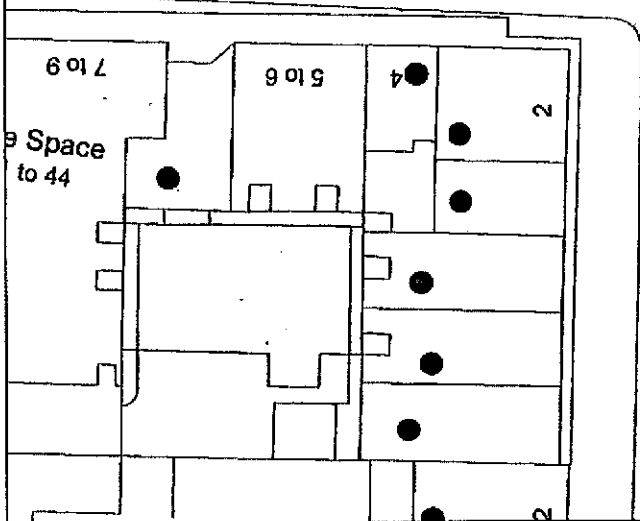

A = 550 m² TOTAL
 B = 270 m² 1255 m²
 C = 360 m²
 D = 75 m²

Scale: 1:650 (appx)

Date: 06 June 2012

Ref:

Drawn:

Base map: SP3166SE

Scale
 0 4 8 12 16 20 m

